

# EL HENRY

GESTURE MARKUP WITH INSPIRATION IMAGES

**PROLOGUE:** "WELCOME TO AZTLAN CITY, FORMERLY KNOWN AS SAN DIEGO, CAPITAL OF AZTLAN. NOW AZTLAN IS BASICALLY CALIFORNIA AFTER THE GRINGO EXODUS...SO FIFTY MILLION MEXICANS FLED NORTH, CROSSING THE BORDER INTO CALIFAS." (PG. 4)



**EMOTION:** Taking place in a once "white" world, we walk into the space and are greeted with a loud, abrasive, and unapologetic atmosphere. We see piles of a dead "gringo" world that is now being transformed into the birth of a world that can be best described as rascuache. The barrios are taking over with their

resources re-building what they can with what they have available which gives us the opportunity to use the piles of trash to stick lights in whatever the hell we can to create this world of rascuache. With the set, piles of trash, trusswork, foliage, and lights working together, we create a chaotic world that is full of texture and shadows. In pre-show, we start off in the shadows and cool tones of this world and as soon as we begin with the prologue, the world opens up slightly with bold pops of color to represent lively Latinx culture.

**SCENE 1 - HISPANIC PRESS CONFERENCE:** "WHEN YOU CAN'T MAKE THEM SEE THE LIGHT, MAKE THEM FEEL THE HEAT." (PG. 7)



**EMOTION:** Inspired by current political events, the feeling of this scene is extremely hostile and oppressive. A blast of light will come from the upstage area will hit Mayor Villa. By doing so, the audience will feel the abrasive energy the Hispanics give off.

## GESTURE MARKUP WITH INSPIRATION IMAGES

A 3D digital artwork of a skull, likely representing a character from the anime 'Berserk'. The skull is depicted with a crown of thorns, a spiked collar, and a large cross necklace. The lighting is dramatic, with red and blue hues, creating a dark and intense atmosphere. The skull's eyes are closed, and its mouth is slightly open, showing teeth. The background is dark, with some faint, glowing elements.



**SCENE 3: CHIQUI'S TAVERN: "THE DEVIL SHALL HAVE HIS BARGAIN." (PG. 22)**

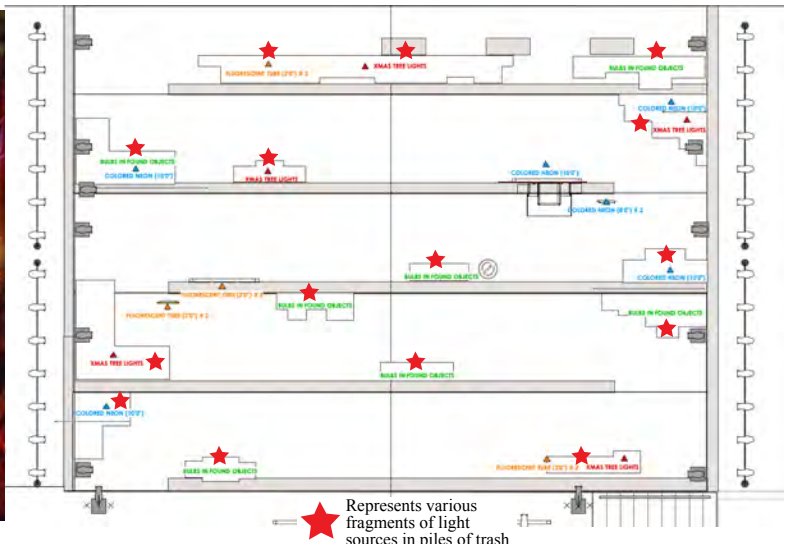



# EL HENRY

GESTURE MARKUP WITH INSPIRATION IMAGES

## SCENE 4 - MEETING OF GENERALES: "NOW IS THE TIME TO HIT HIM HARD AND TAKE IT ALL FOR OURSELVES. NO MERCY!" (PG. 25)

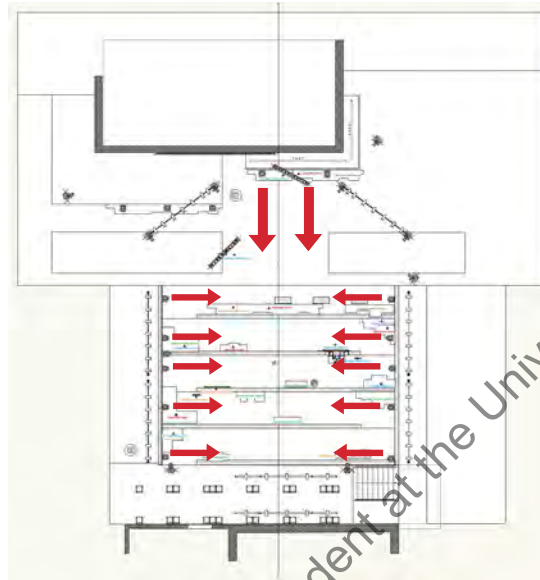

**EMOTION:** You know the feeling you get as you walk down a sketchy-ass street or neighborhood alone? You have no idea who is out there or what you're going to run into but the feeling that something could happen is something you can't shake off. The energy is crucial and will be represented with heavy shadows and from the "Car" as it enters the space, we slammed with an intense blast of light

coming from the upstage area. A chemical green-yellow and sickly green color palette will be used to provide the audience a sense of how sketchy this underpass is.

## SCENE 5: CHIQUI'S TAVERN: "THE FAMILIA NEEDS YOU. REBELLION IS IN THE AIR." (PG. 36)

**EMOTION:** As we return to Chiqui's bad ass tavern, we are reminded of the powerful energy this *chingona* has. We are reminded of how she who is not afraid any *carbrones* and her tavern has constant *puro pinche* party vibes. Here again, see the trash piles glow. The lively color palette of saturate ambers, purples, blues, and reds will help boost the is vibrant, energetic, and *in your face* vibe.

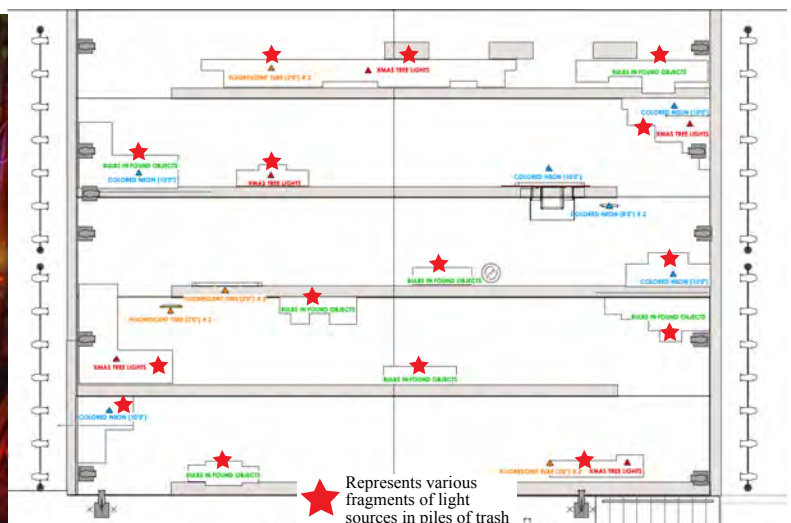

# EL HENRY

## GESTURE MARKUP WITH INSPIRATION IMAGES

**SCENE 6 - JUNKYARD:** "THIS IS NOT THE TIME FOR LOVE, MUNECAS, AND BESITOS. CHALE. THERE IS ONLY TIME FOR BLOODY NOSES AND CRACKED CROWNS AND I'LL GLADLY SPREAD THEM AROUND." (PG. 40)

**EMOTION:** Even though something romantic just occurred, El Bravo means business with the current political situation he is in. There are a few romantic elements to this scene and will be represented by nearby piles of trash illuminating the couple. Although side light will be the main driving force (similar to the image on the right), the off-putting romantic blue and amber color palette (similar to the image on the left) will give off that agitated push that this scene calls for.

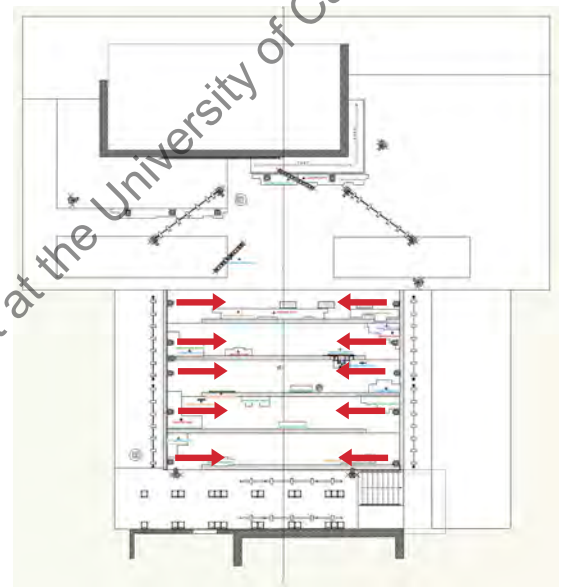

**SCENE 7 - SAFE HOUSE OF BARRIO EASTCHEAP:** "POR VIDA Y POR SANGRE!" (PG. 47)



**EMOTION:** Returning to Barrio Eastcheap, we are reminded of the protective energy that is observed in the Latinx culture as well as seeing how intimidating El Hank gives off that energy. We see El Hank in his throne and that in itself is intimidating: he is a man of stature and power and will destroy anyone and anything who messes with his *familia*. Even though tensions are rising, a nearby trashcan gives off a warm glow for the surrounding space but for the throne, El Hank will have a glow around his throne in order to give off the type of energy that screams "NO CHINGES CONMIGO!"



# EL HENRY

GESTURE MARKUP WITH INSPIRATION IMAGES

## SCENE 8 - BARRIO HOTSPUR SAFE HOUSE: "THE STREETS ARE QUIET BUT EVERYONE KNOWS SOMETHING IS GOING DOWN." (PG. 47)

**EMOTION:** Similar to the scene under the overpass, this scene has the unfortunate feeling that something is bound to happen. The streets are too quiet... and you know some shit is about to go down. That tense energy is something that is a crucial element and will be represented with heavy shadows coming from side lights and a chemical green-yellow and sickly green color palette will be used to provide the audience a sense of how sketchy this underpass is.



## SCENE 10 - BARRIO EASTCHEAP STREET CAMP: "I'M READY, JEFE. LET US DELIVER BARRIO HOTSPUR THE FATE IT TRULY DESERVES. I GOT ALL OUR SOLDERS IN FORMATION AND READY, JEFE." (PG. 49)

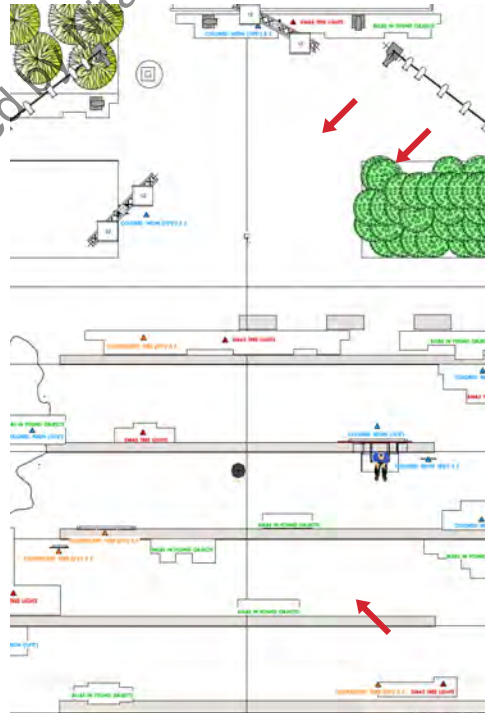
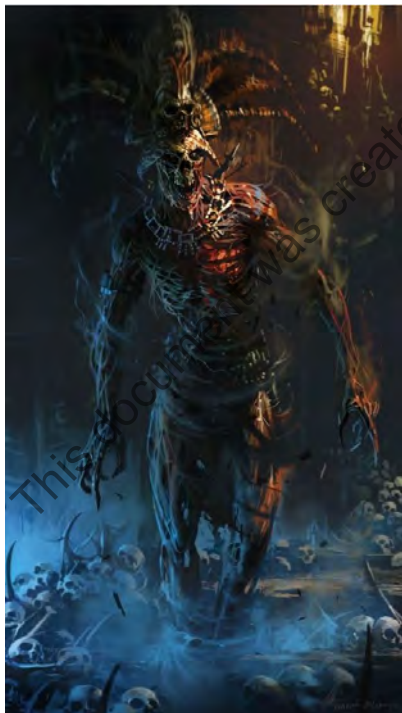

**EMOTION:** El Henry is *darle en la madre* with this fight. He is reborn into the family and is willing to do whatever it takes to keep his *familia*'s pride in check. *El valiente* is ready to fight. With this rebirth into the family, we see this powerful version of El Henry as he is now a protector of *la familia* and everything about this new man is met with harsh, yet angelic beams of light. Amber will be used to show the strength and rebirth El Henry is experiencing as if to represent a phoenix rising from the ashes.

# EL HENRY

GESTURE MARKUP WITH INSPIRATION IMAGES

## SCENE 11 - BARRIO HOTSPUR SAFE HOUSE: "FUCK, NO. WE AIN'T BACKING DOWN." (PG. 54)



**EMOTION:** With a more tense energy, we return to witnessing El Bravo's mission to seek revenge on El Hank and El Henry. The vibe is off and similar to the scene at the underpass, we are getting to the point where we are convinced that shit is about to go down. Streets aren't as quiet but still reserved in energy. This tense atmosphere is a main driving point that will be represented with heavy shadows coming from side lights and a chemical green-yellow and sickly green color palette will be used to provide the audience a sense of how sketchy this environment is.

## SCENE 12 - BARRIO EASTCHEAP CAMP: "WHAT IS HONOR? A WORD. A PALABRA. WHAT IS IN THIS WORD 'HONOR'? AIR. AIRE. IT'S FREE." (PG. 56)



### EMOTION:

Even though Fausto delivers this cathartic monologue, we still experience a state of isolation and intimacy. As Fausto is experiencing this moment, a bold, warm source of light will surround them to highlight this moment.



# EL HENRY

GESTURE MARKUP WITH INSPIRATION IMAGES

## SCENE 13 - BARRIO HOTSPUR SAFE HOUSE: "HASTA LA MUERTE." (PG. 58)

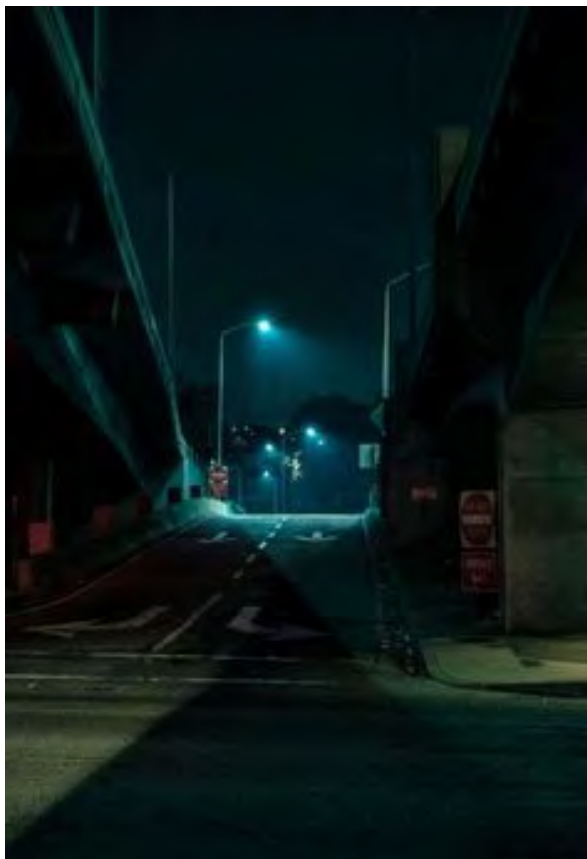

**EMOTION:** With a more violent energy, we return to witnessing El Bravo's plot destroy El Hank and El Henry. This is the point of no return. This tense atmosphere will be represented with heavy shadows coming from side lights and a chemical green-yellow and sickly green color palette will be used before the audience is hit with a blast of saturate colors that will be seen in the following scene.

## SCENE 14 - THE BATTLEFIELD: "NO MATTERS WHAT HAPPENS TONIGHT, I CAN DIE SMILING. LOOK AT THIS, CARNALES FIGHTING SHOULDER TO SHOULDER DEFENDING THEIR FAMILIA, THEIR HONOR." (PG. 60)



**EMOTION:** The battle scene is like a violent party, a bar fight, or a mosh pit at a punk rock concert. The color palette will be saturate and unapologetic. Neon, fluorescent tubes, and found objects in and around the piles of trash are flickering. We see lights flashing as putasos are thrown along with lights coming on from various angles. Everything is random and abrasive adding a kinetic energy to this scene.

# EL HENRY

## GESTURE MARKUP WITH INSPIRATION IMAGES

### SCENE 15 - THE FINAL SHOWDOWN ON BATTLEFIELD: "MANO A MANO. FILEROS ONLY. NO CUETES." (PG. 62)

**EMOTION:** With a similar vibe to the previous battle scene, this one-on-one battle scene has stakes that are more violent and "serious". With the aim to create tension, contrasting colors and side light will be used to create a clash of energy between El Henry and El Bravo. As the characters throw *putasos*, the chaotic world around them flashes, as if they are affecting the natural world around them.

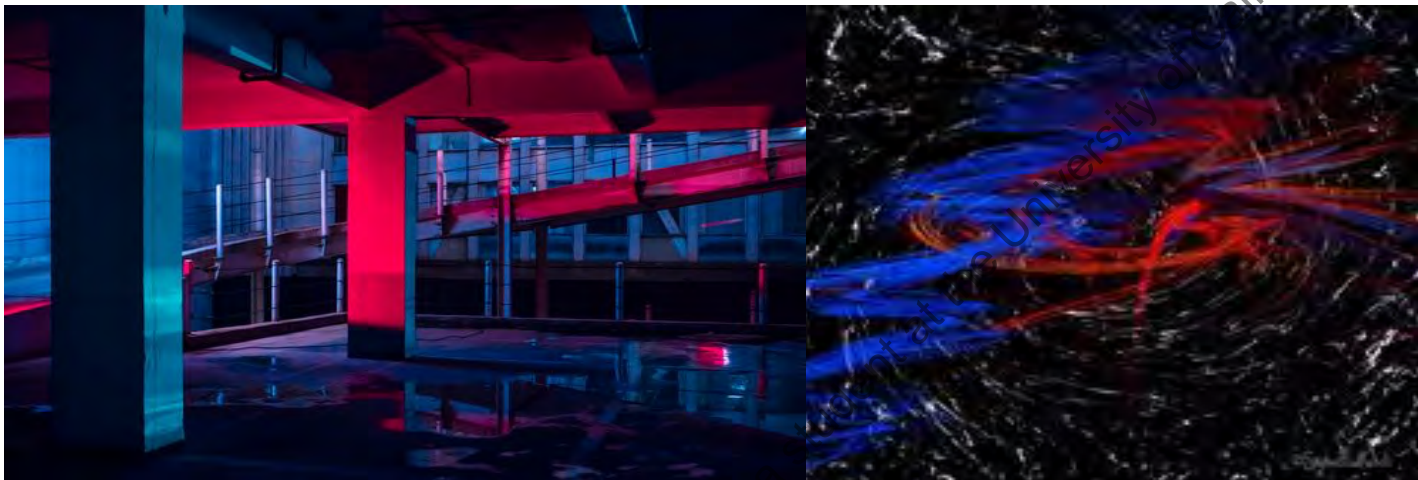

### SCENE 16 - CHIQUI'S TAVERN: "THIS IS A NEW DAY. WE HAVE SEEN TOO MUCH PAIN AND MUERTE AND IT'S TIME TO TURN A NEW PAGE. WE NEED TO GO BACK TO BASIC PRINCIPLES AND FOUNDATIONS OF AZTLAN. A BROTHERHOOD AND SISTERHOOD OF RESPECT, HONOR, AND CARING FOR EACH OTHER." (PG. 66)



**EMOTION:** This is the final moment that we get to see and experience the *pinche* party. Everyone has this newfound positive outlook towards the future, the tension is completely gone, and it's time for throw a baller time with the *familia*. There are no more bad vibes and the space opens up completely with a lush color palette.